

WrapidSeal™

Heat shrinkable manhole encapsulation system

System Components

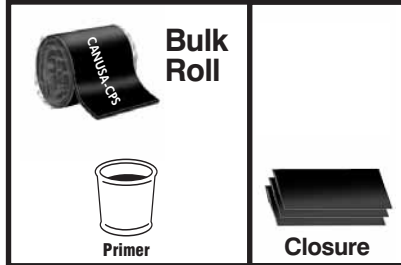

WrapidSeal is typically shipped in bulk rolls. Closures are shipped pre-cut. The adhesive is protected from contamination by an inner liner. Primer is sold separately.

Storage & Safety Guidelines

To ensure maximum performance, store Canusa products in a dry, ventilated area. Keep products sealed in original cartons and avoid exposure to direct sunlight, rain, snow, dust or other adverse environmental elements. Avoid prolonged storage at temperatures above 95°F (35°C) or below -4°F (-20°C). Product installation should be done in accordance with local health and safety regulations.

These installation instructions are intended as a guide for standard products. Consult your Canusa representative for specific projects or unique applications.

Equipment List

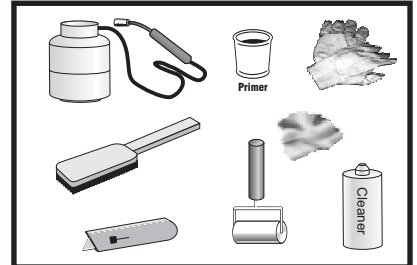

Propane tank, hose, torch & regulator. Appropriate tools for surface abrasion. Knife, roller, rags & approved cleaner. Wire brush, paint brush or paint roller, tape measure, and marker. Standard safety equipment; gloves, goggles, hard hat, etc.

Product Preparation Guidelines

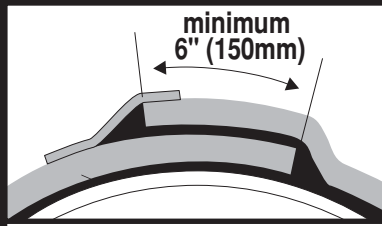

Sleeve Length = Manhole Circumference + 6" (150mm)

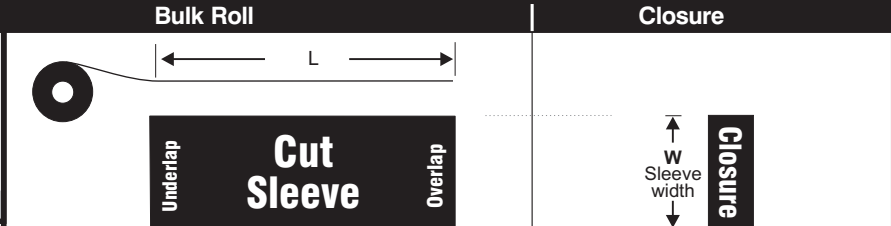

Bulk Roll **Closure**

← L →

Underlap **Cut Sleeve** Overlap

↑ W ↓
Sleeve width

Closure

As a guideline, cut the required lengths of Sleeve material (L) and Closure material (W) from the bulk roll as follows

L = Manhole structure circumference + overlap dimension
W = Sleeve Width

Ensure that the sleeve and closure are not damaged or contaminated.

Surface Preparation

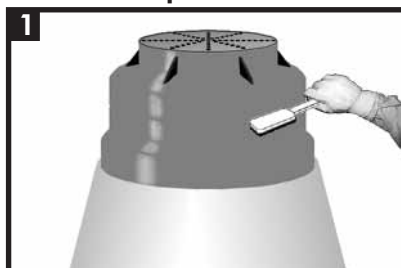

Ensure all surfaces which the sleeve will be applied to are clean, dry and free of foreign objects and sharp edges.

Sleeve Sizing

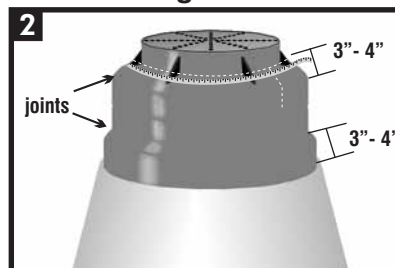

WrapidSeal™ should be sized to extend 3" - 4" above and below the upper and lower joints of the cone section, grade rings and frame. As a guide, make a series of marks around the manhole where the bottom of the sleeve will be. Determine the layflat length of the sleeve by measuring the circumference of the manhole structure at the marks and add the overlap dimension, (6" minimum).

Pre-Heat

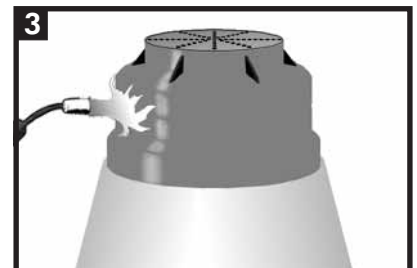

Using the torch, warm the surface to drive off any moisture.

WrapidSeal™

Primer Application

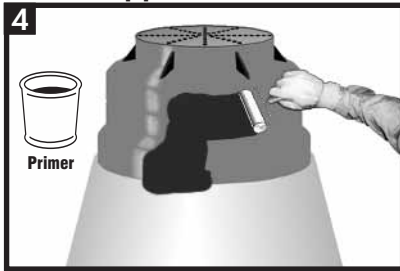

Apply WrapidSeal™ Primer to the application surfaces, (i.e. steel, concrete, fiberglass etc.) Wait until the primer is slightly tacky to touch before proceeding. This will take 5-15 minutes depending on temperature and humidity conditions.

Sleeve Preparation

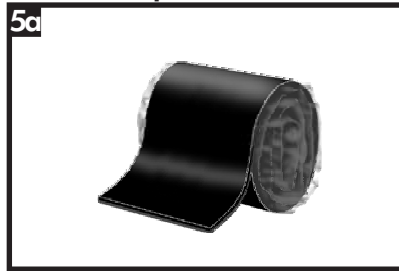

Roll up the cut sleeve ensuring that the release liner is still on the adhesive backing

Caution: Do not allow exposed adhesive to fold over on itself.

Sleeve Wrapping

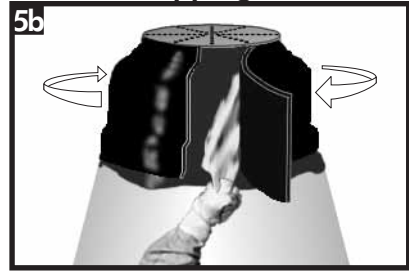

Remove ~6" of the release liner from the sleeve. Using the perimeter marks as a guide, begin wrapping the sleeve around the manhole while gradually removing the release liner.

Sleeve Overlap



At the overlap, ensure that the top and bottom edges of the sleeve are uniformly aligned.

Closure Installation



Place the closure seal on a flat surface (adhesive side up) and apply gentle heat to activate the adhesive. Center the closure vertically over the overlap and apply a small amount of heat to the face of the closure. Using a gloved hand pat the closure down and, alternating with heat and pressure. Continue until the closure is fully bonded.

Sleeve Shrinking

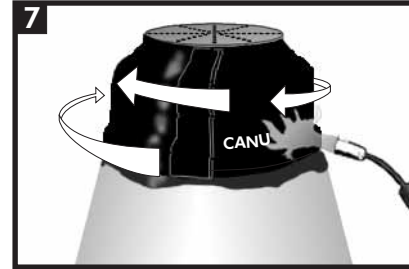

Using a moderate to high flame, begin heating the sleeve from the bottom edge. Apply heat circumferentially around the structure. Continue heating upward as the sleeve shrinks. Use a gloved hand or roller to smooth wrinkles and push out trapped air.

Sleeve Finishing

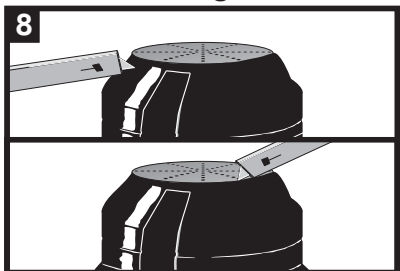

After shrinking, WrapidSeal™ will be draped over the manhole frame gussets. Using a knife, cut the sleeve around the gussets. Apply gentle heat and press the sleeve onto the steel frame. Trim excess material protruding above the steel manhole frame and cover.

Inspection

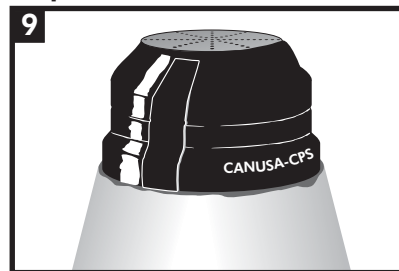

Visually inspect the installed sleeve for the following:

- Sleeve is in full contact with the cone section and manhole frame
- Adhesive flows beyond the sleeve edges
- No cracks or holes in the sleeve backing

Backfilling Guidelines

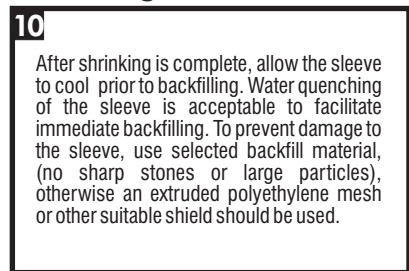

After shrinking is complete, allow the sleeve to cool prior to backfilling. Water quenching of the sleeve is acceptable to facilitate immediate backfilling. To prevent damage to the sleeve, use selected backfill material, (no sharp stones or large particles), otherwise an extruded polyethylene mesh or other suitable shield should be used.

Please contact manufacturer's representative when considering use of WrapidSeal™ on above grade structural applications.

Master Distributor in the United States:
CCI Pipeline Services
 Houston, Texas
 www.WrapidSeal.com
 e-mail: sales@wrapidseal.com
 tel: (281) 350-2100



A SHAWCOR COMPANY

Canada

CANUSA-CPS
 a division of SHAWCOR LTD.
 25 Bethridge Road
 Rexdale, Ontario
 M9W 1M7,
 Canada
 Tel: +1 (416) 743-7111
 Fax: +1 (416) 743-5927

U.S.A./Latin America

CANUSA-CPS
 a division of SHAWCOR INC.
 2408 Timberloch Place
 Building C-8
 The Woodlands, Texas
 77380, U.S.A.
 Tel: +1 (281) 367-8866
 Fax: +1 (281) 367-4304

Europe/Middle East

CANUSA-CPS
 a division of Canusa Systems Ltd.
 Unit 3, Sterling Park
 Gatwick Road
 Crawley, West Sussex
 England RH10 9QT
 Tel: +44 (1293) 541254
 Fax: +44 (1293) 541777

www.canusacps.com

Asia/Pacific

CANUSA-CPS
 a division of SHAWCOR LTD.
 #05-31, B1K 52, Frontier
 Ubi Avenue 3
 Singapore
 408867
 Tel: +65-6749-8918
 Fax: +65-6749-8919

Canusa warrants that the product conforms to its chemical and physical description and is appropriate for the use stated on the installation guide when used in compliance with Canusa's written instructions. Since many installation factors are beyond our control, the user shall determine the suitability of the products for the intended use and assume all risks and liabilities in connection therewith. Canusa's liability is stated in the standard terms and conditions of sale. Canusa makes no other warranty either expressed or implied. All information contained in this installation guide is to be used as a guide and is subject to change without notice. This installation guide supersedes all previous installation guides on this product. E&OE